

Creating Home-like Environments for People with Dementia

Research & Programming Document

Jessica Stephens

Fall 2023

DESIGN IMPLICATIONS

The Village Langley



1. HOME-LIKE ENVIRONMENT

This dementia village emphasizes the unique care utilized in this environment, with a small, homelike scale and few amenities within the residence.

- Small, human scale that represents a home environment
- A large, open area connecting the living room, kitchen, and dining room brings a sense of home.
- Maintaining private bedrooms with the personalization of home decor.
- Allowing space for personal items/ decor can help the space feel more at home, for example, built-ins/ casework.

The Memory Care Center- Atlanta



2. WAYFINDING

This dementia care facility highlights the use of separate wings with individual characteristics for each wing for residents to identify their living quarters.

- Designs should have a distinct appearance and an overall layout with unique and varied landmarks.
- Recognizable objects and artworks are the best design choices for wayfinding. Color is another good indication.
- Exterior views are also a wayfinding method as well.
- Personal decor from home outside of the rooms to recognize their room.
- The layout is open and continuous, which allows for wandering and meaningful and purposeful expression.

Carpe Diem



3. OUTDOOR SPACES

This dementia village has beautiful landscapes for residents to enjoy in their downtime. It promotes well-being and encourages walking with an emphasis on physical health.

- Healing gardens create a therapeutic activity that relieves stress and promotes well-being and physical therapy.
- Creating seating areas to promote community and socialization.
- Smaller potting areas to create an additional outdoor activity.
- Using landscape to create boundaries but providing space for people to move.

DESIGN IMPLICATIONS

De Hoegeweyk



4. SAFETY & SECURITY

Residents are free to wander on this enclosed campus with beautiful landscapes. Staff is available at all times, but they are often dressed as they would be in everyday spaces instead of in a healthcare environment.

- People feel safe due to elements of the built environment
- Technology throughout the building to assist residents with tasks
- The layout encourages wandering but in a safe, habitual environment
- Safety call buttons in the rooms to alert caregivers if there is an emergency.
- Motion sensors are incorporated throughout the building to ensure the resident's safety if a fall occurs.

HarborChase of South Portland



5. COMMUNITY

This assisted living facility hosts an array of amenities on-site for residents to enjoy to promote community, such as this large dining area; others include a hair salon, restaurant, etc.

- Having areas for people to connect allows for social interaction and engagement, which results in improved well-being.
 - Providing other areas besides the private quarters for residents to entertain guests/visitors
 - It relieves stress and helps with the feeling of people feeling cooped up.
-

SPATIAL PROGRAM

Space	Quantity	Area	Subtotal Area
Bedroom	10	350 sq. ft.	3500 sq. ft.
Living Room	1	600 sq ft	600 sq. ft.
Kitchen	1	500 sq. ft.	500 sq. ft.
Dining Room	1	100 sq. ft.	100 sq. ft.
Restroom	16	60 sq. ft.	960 sq. ft.
Laundry	1	100 sq. ft.	100 sq. ft.
Library	1	400 sq. ft.	400 sq. ft.
Theater	1	300 sq. ft.	300 sq. ft.
Activity Room	1	2000 sq. ft.	2000 sq. ft.
Fitness Room	1	3000 sq. ft.	250 sq. ft.
Staff Area	4	1000 sq. ft.	4000 sq. ft.
Restaurant	1	3000 sq. ft.	3000 sq. ft.
Cafe	1	200 sq. ft.	200 sq. ft.
Outdoor Space	1	5000 sq. ft	5000 sq. ft.

SPATIAL PROGRAM

Circulation Estimate	Grand Total	Furniture Use
875 sp. ft.	4375 sq. ft.	Bed, bench, armchair, dresser, nightstand, chest, TV
150 sq. ft.	750 sq ft	Sofa, armchair, side tables, fireplace, TV, storage walls
125 sq. ft.	625 sq. ft.	Island with seating, cabinets, oven, refrigerator, microwave
25 sq. ft.	125 sq. ft.	Table, chairs, chests, mirror
240 sq. ft.	1200 sq. ft.	Toilet, sink, shower, grab rails
25 sq. ft.	125 sq. ft.	Washer, dryer, storage (shelving)
100 sq. ft.	500 sq. ft.	Storage walls, armchairs, chaise
75 sq. ft.	375 sq. ft.	Lounge chairs, projector, snack storage
500 sq. ft.	2500 sq. ft.	Tables, chairs, storage, screen with projector
750 sq. ft.	3750 sq. ft.	Yoga mats, dumbbells, exercise chairs, mirror walls
250 sq. ft.	1250 sq. ft.	Tables, chairs, desks, storage
750 sq. ft.	3750 sq. ft.	Tables, chairs, bars, bar seating, hostess stand
50 sq. ft.	250 sq. ft.	Bar with cash register seating, tables, chairs
1250 sq. ft.	6250 sq. ft.	Lounge seating, tables, umbrellas,

ADJACENCY MATRIX

LEVEL 1

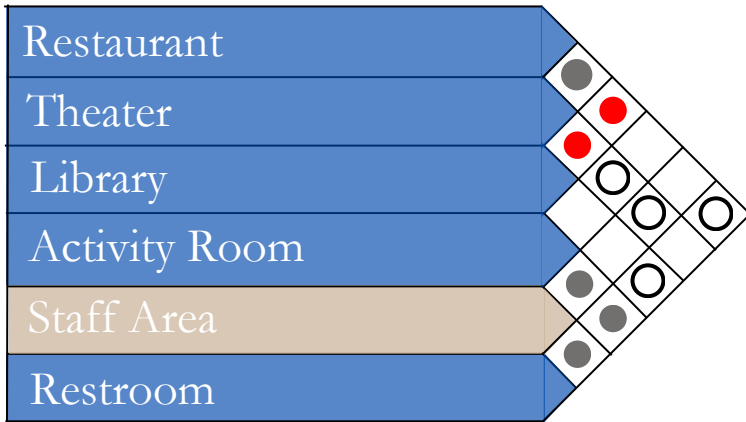

KEY	
PUBLIC SPACE	
SEMI-PUBLIC SPACE	
PRIVATE SPACE	
PRIMARY ADJACENCY	●
SECONDARY ADJACENCY	○
SEPARATE ADJACENCY	●
NEUTRAL ADJACENCY	

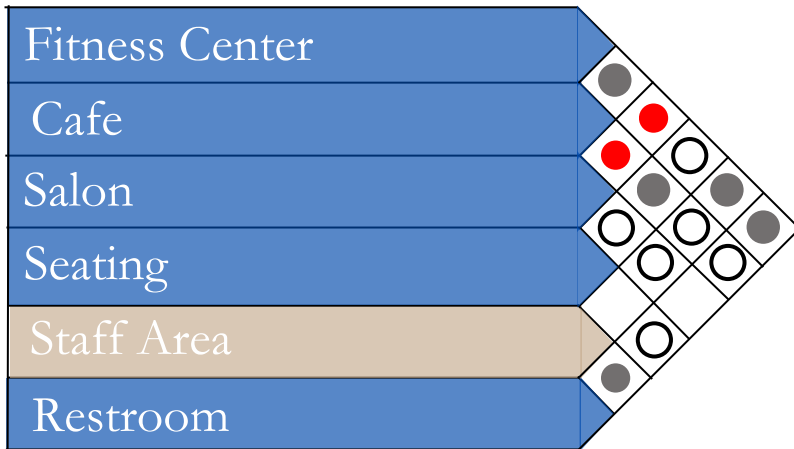

KEY	
PUBLIC SPACE	
SEMI-PUBLIC SPACE	
PRIVATE SPACE	
PRIMARY ADJACENCY	●
SECONDARY ADJACENCY	○
SEPARATE ADJACENCY	●
NEUTRAL ADJACENCY	

LEVEL 2

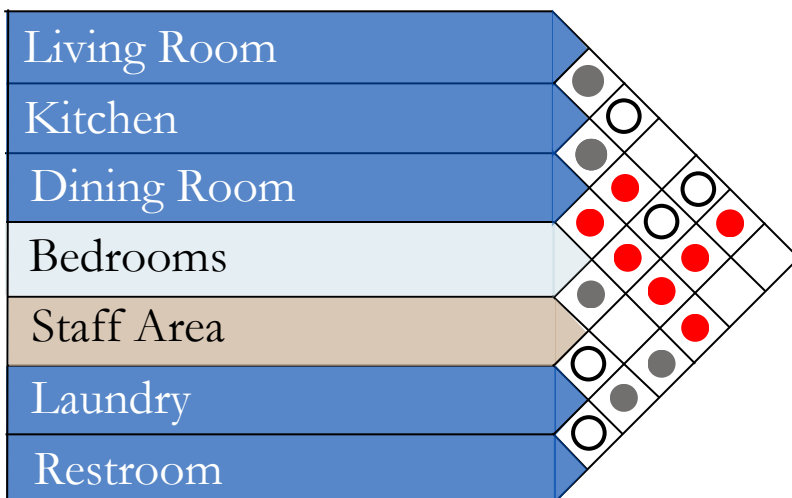

KEY	
PUBLIC SPACE	
SEMI-PUBLIC SPACE	
PRIVATE SPACE	
PRIMARY ADJACENCY	●
SECONDARY ADJACENCY	○
SEPARATE ADJACENCY	●
NEUTRAL ADJACENCY	

BUBBLE FLOW/ CIRCULATION



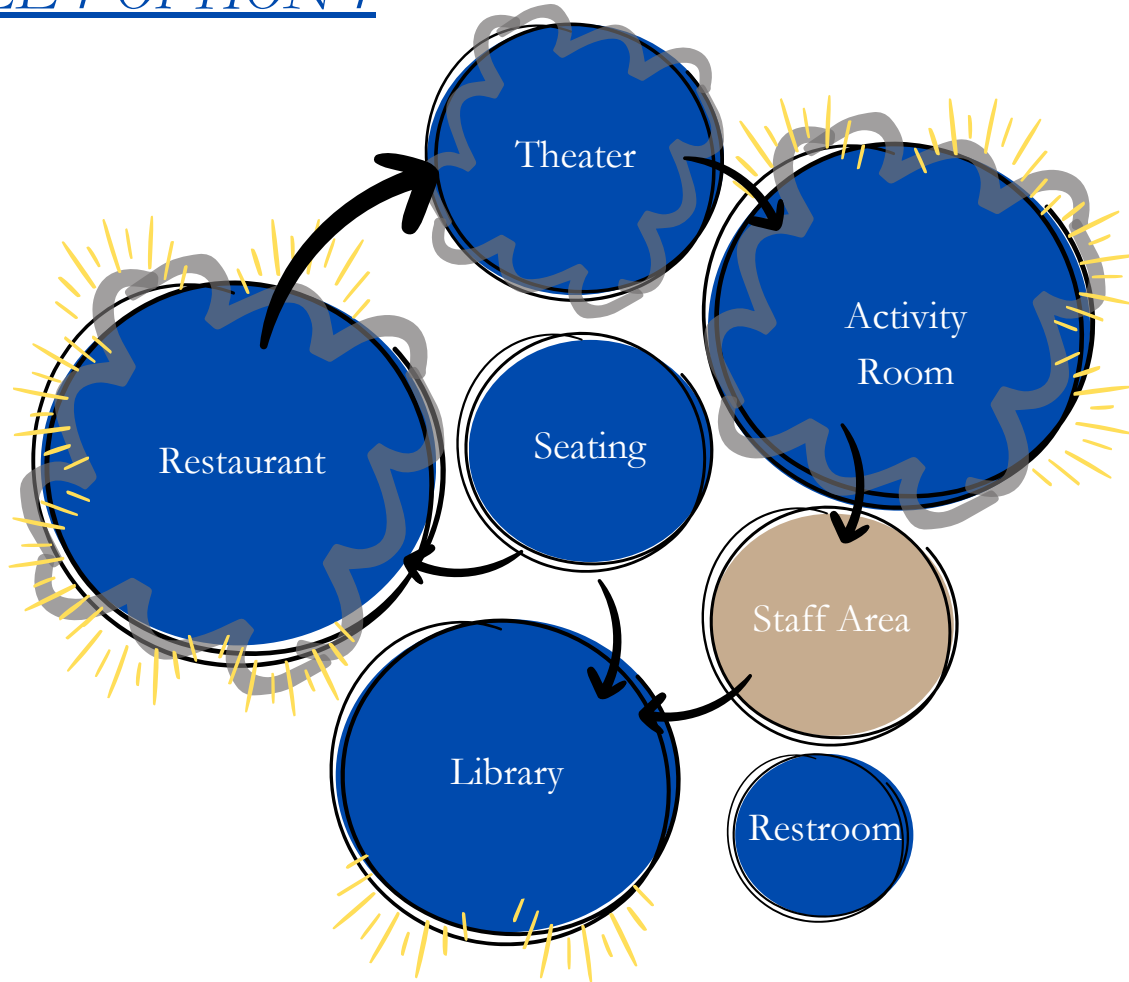

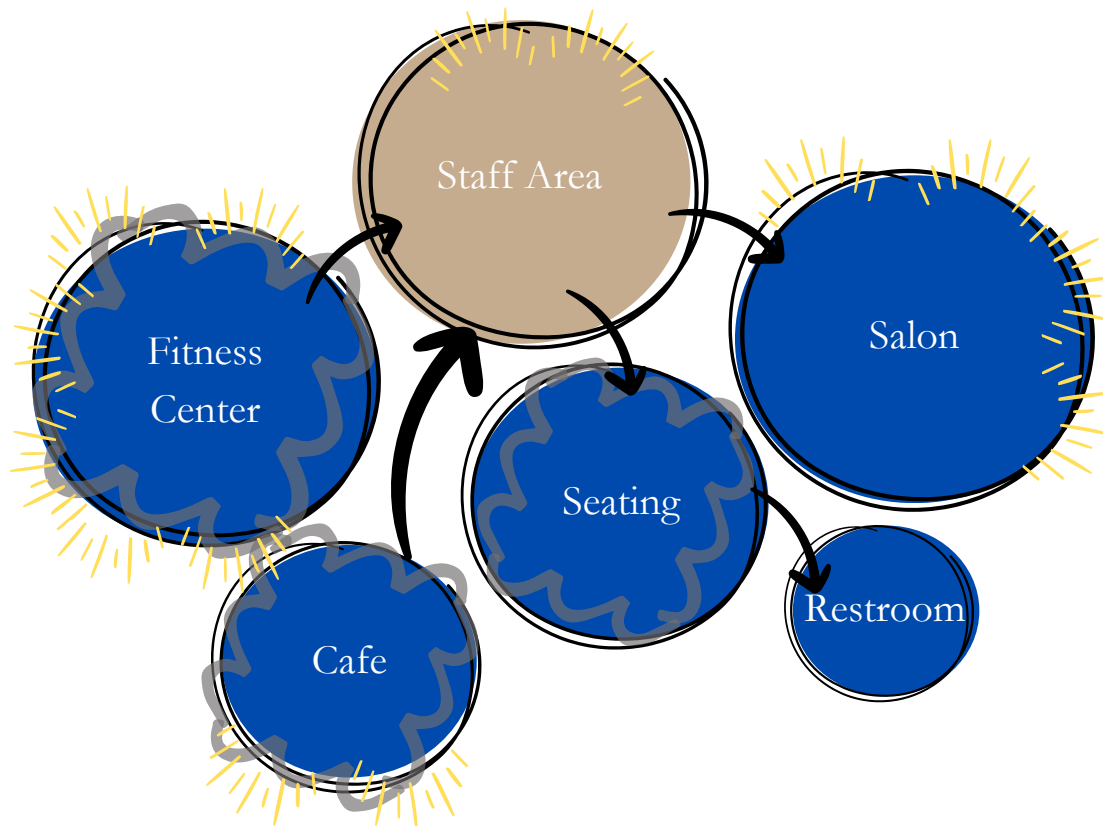

LEVEL 1 OPTION 1



LEVEL 1 OPTION 2



Key:

-  Public Space
-  Semi-Public Space
-  Private Space
-  Circulation
-  Daylight Exposure
-  Acoustics

BUBBLE FLOW/ CIRCULATION

LEVEL 2 OPTION 1

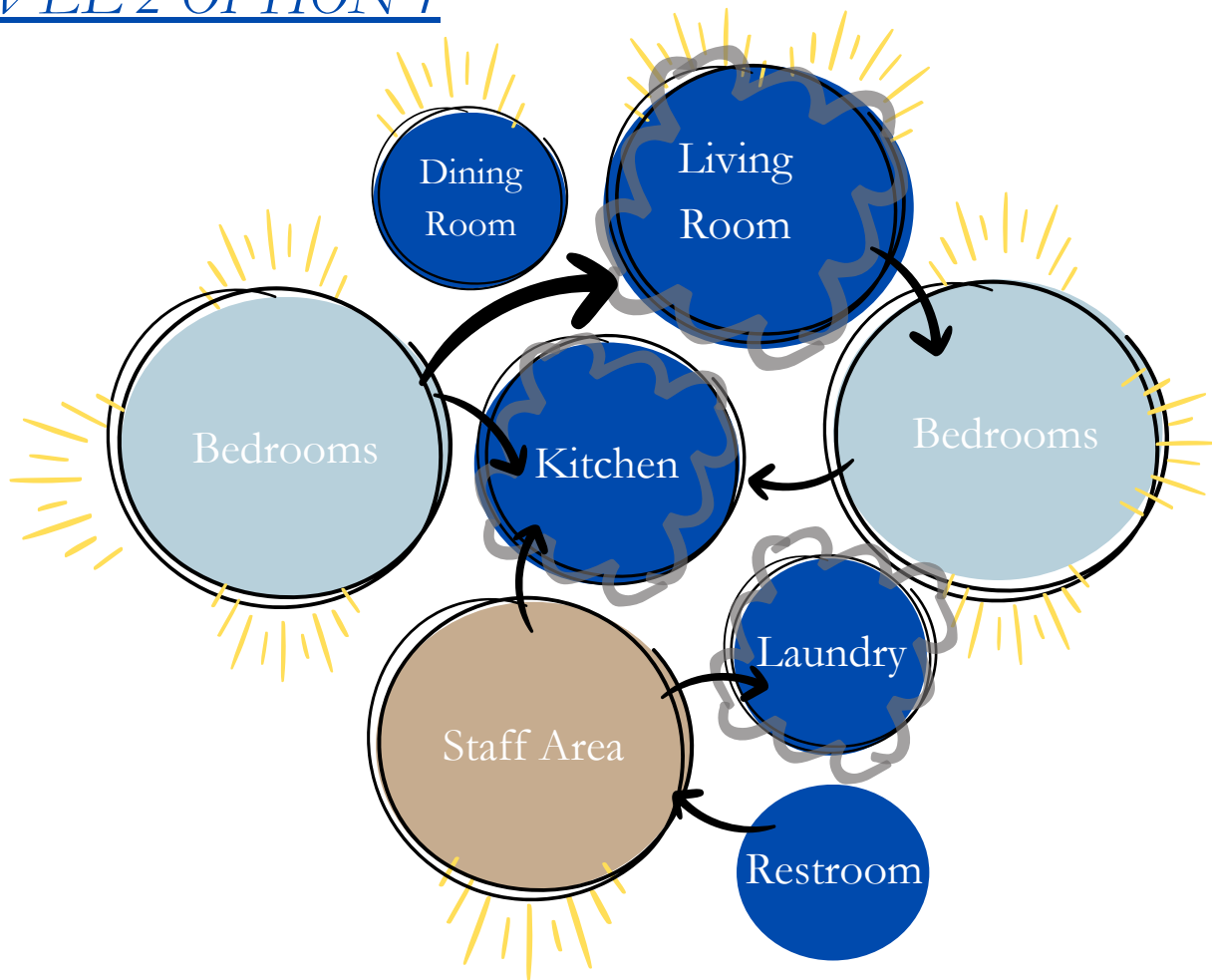

LEVEL 2 OPTION 2

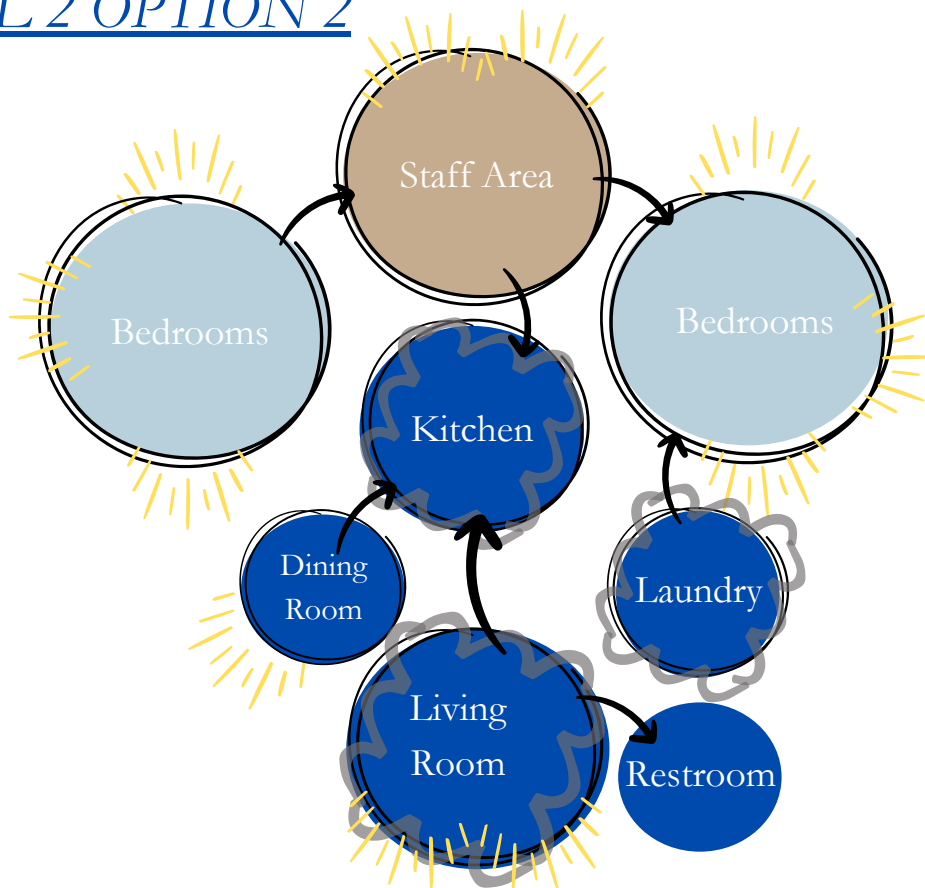

Key:

- Public Space
- Semi-Public Space
- Private Space
- Circulation
- Daylight Exposure
- Acoustics